

成品尺寸:65*175mm

纸材：60g双胶纸

颜色：单色黑 K100

工艺：3折4页风琴页

封面

封底

175mm

65mm

EN Thank you for purchasing the electric wine opener.

BEFORE USING FOR THE FIRST TIME

To ensure safety and maintain the high quality of the product, we recommend that you read and follow the instructions carefully.

- Do not immerse the appliance in water or any other liquid to avoid harm to human or the product.
- Keep body parts (e.g. hands) and utensils away from corkscrew to avoid damage.
- Keep this product away from children.
- Do not dismantle the product by yourself.
- Do not press the product onto a bottle with sudden force or attempt to speed up the mechanism. This product works best when operating at its intended speed.
- No extended use is allowed.
- Keep away from flammable, explosive gas.
- Using the product in any manner not described in these instructions releases the manufacturer from all liability.

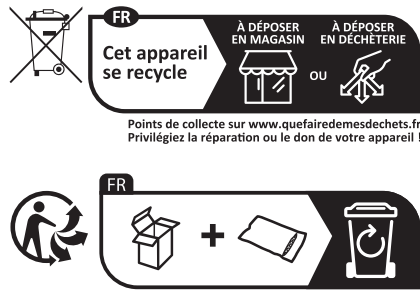

PRODUCT DESCRIPTION

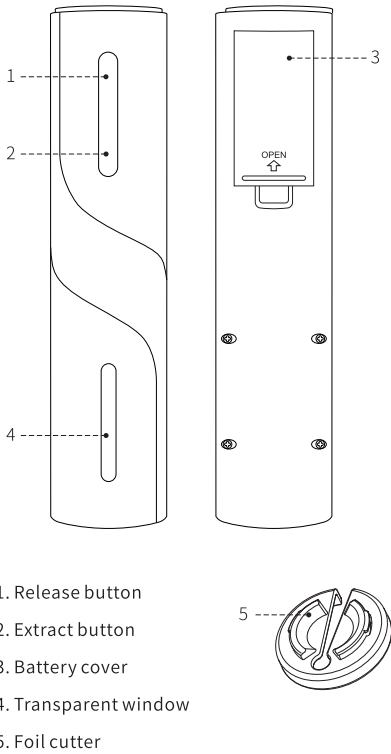

HOW TO INSTALL THE BATTERIES

- Press the arrow on the battery cover with fingers and pull it up by force to open the battery cap.

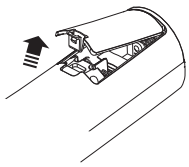

- Insert 4 pieces of AA alkaline batteries according to the positive and negative terminals.

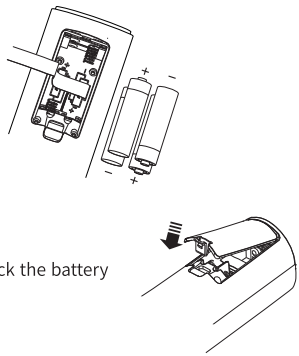

HOW TO USE THE WINE OPENER

Take the foil cutter off and put onto the bottleneck, hold with fingers by force, rotate the bottle in parallel for more than one circle, and cut off the foil seal.

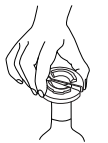

Hold the bottle firmly with one hand and hold the wine opener with the other. Place the bottom of opener body on top of the wine bottle to ensure the opener body remains in line with the wine bottle as much as possible.



Press the extract button and hold, slightly press the opener body downward at the same time. The spiral will turn in a clockwise direction and enter the cork, then gradually remove it from the bottle in seconds. When the cork is entirely pulled out, the wine opener stops automatically. Release the button and take the opener off from the bottle.

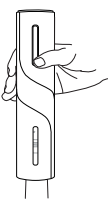

Press the upper release button and hold for seconds, the cork automatically comes out from the opener, release the button, and complete the opening process.



*This product is suitable for corks with a diameter of 20 mm to 24 mm and a height of 44 mm.

*This product is suitable for wine bottles with an bottleneck outer diameter of not more than 35 mm and an bottleneck inner diameter of 17.5 mm to 23 mm.

CAUTIONS

- Hold the wine opener body and the wine bottle firmly during use.
- The blade of the foil cutter is sharp. Do not touch it with your fingers.
- Please store this product out of reach of children.
- Align the wine opener body with the wine bottle as much as possible, otherwise the cork cannot be easily pulled out.

TROUBLE SHOOTING

If the opener does not work or stops during uncorking:

- Please check that the batteries are alkaline batteries.
- Please check that the batteries are installed correctly.
- Please confirm there is sufficient battery power.
- Please confirm that the wine opener is aligned with the wine bottle vertically during the opening process.

If the above operations are all correct and the opener still works abnormally, please contact the vendor for maintenance service.

C 感谢您购买本电动开瓶器。

首次使用产品前

为确保安全并保持本产品的高品质,我们建议您仔细阅读使用说明,并严格遵守这些指示。

- 禁止把本产品放入水或其它液体中,以免对人体或产品造成损伤。
- 使用时手及家用器具不要触及到螺旋钩以免造成损伤。
- 禁止儿童使用本产品。
- 禁止用户私自拆卸本产品。
- 禁止猛力将本产品压在酒瓶上,或试图加快开瓶的速度。本产品在其设定速度下工作效果最佳。
- 请不要把本产品作其它用途使用。
- 请不要在有易燃、易爆性气体周围使用本产品。
- 不按照说明书中列明的使用方法使用,制造商将不承担任何责任。

产品规格

品 名: KB1-601901A电动开瓶器
型 号: KB1-601901A
执行标准: Q/KLT 26
额定电压: 6V
额定功率: 25W
工作噪音: <75dB
主要材质: ABS、PC
产品尺寸: φ48*231mm
产品重量: 234g±10g (不含电池)
注:产品规格参数因测量方式不同,可能略有差异,具体以实物为准。

产品描述

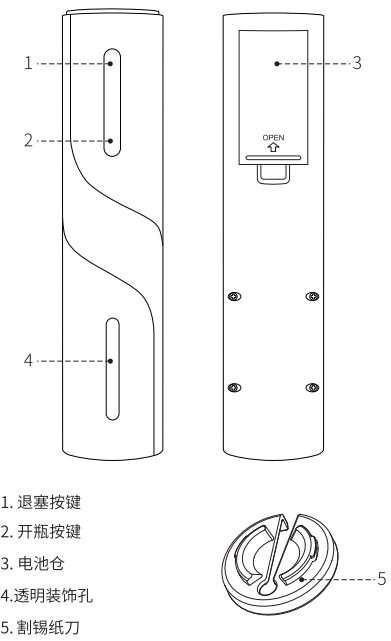

如何安装电池

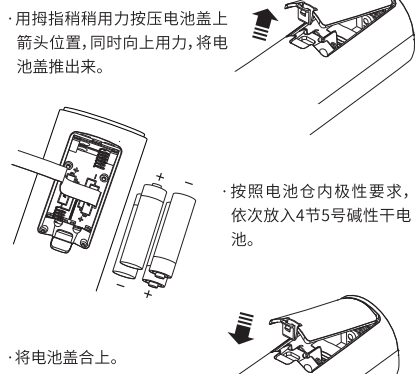

如何使用开瓶器

将割锡纸刀取下来,卡在酒瓶口上,手指稍微用力并保持,平行左右转动,即可割下锡纸帽。

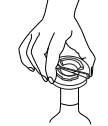

一只手牢固扶住酒瓶,另一只手握住开瓶器主体,将开瓶器主体下端套在红酒瓶口上,尽量保持开瓶器主体与红酒瓶对直。

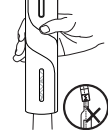

按下开瓶按键并保持住,同时稍微向下压开瓶器主体,开瓶器自动将红酒塞拔出来,当酒塞被完全拔出后,开瓶器将自动停止工作,此时可松开开瓶按键,将开瓶器从酒瓶上取下来。

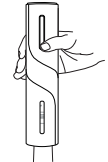

按下上方的退塞按键并保持住,红酒塞会自动从开瓶器主体中退出,松开按键,全过程结束。

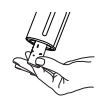

*本产品仅适用于直径为20-24mm,高度为44mm的木塞。
*本产品仅适用于瓶口外径不大于35mm,瓶口内径为17.5-23mm的酒瓶。

安全提示

- 建议使用本产品前先用割纸刀将酒瓶上的锡纸帽取下。
- 使用时请握紧本产品的主机,并同时扶稳酒瓶。
- 请将此产品放置在儿童触摸不到的地方存放。
- 使用时尽量保持主体对直酒瓶,否则可能酒塞无法顺利地拔出。

故障与排除

- 按下功能键无反应或拔塞一半就停止工作:
- 请检查电池是否为碱性干电池。
 - 请检查电池是否正确安装。
 - 请检查电池电量是否充足。
 - 请确认开瓶过程中开瓶器主体与酒瓶保持垂直对准状态。如以上操作均正确,开瓶器仍不能正常工作,请联系经销商咨询维修事宜。

限用物质声明

本表格是根据《电子信息产品污染控制限量要求》的行业标准要求,对KB1-601901A电动开瓶器零部件中标注规定的有害物质或元素含量所做的说明。



电子信息产品名称: KB1-601901A电动开瓶器							
部件名称	有害物质						
	铅 (Pb)	汞 (Hg)	铜 (Cu)	六价铬 (Cr)	多溴联苯 (PBB)	多溴二苯醚 (PBDE)	
导线	○	○	○	○	○	○	
电机	○	○	○	○	○	○	
外壳	○	○	○	○	○	○	
螺钉	○	○	○	○	○	○	
弹簧	○	○	○	○	○	○	
PCB板	○	○	○	○	○	○	
螺旋钩	○	○	○	○	○	○	
按键	○	○	○	○	○	○	
齿轮箱	○	○	○	○	○	○	
电池极片	○	○	○	○	○	○	
割锡纸刀	○	○	○	○	○	○	
胶袋	○	○	○	○	○	○	
包装印刷品	○	○	○	○	○	○	

本表格依据SJ/T 11364的规定编制。
○:表示该有害物质在该部件所有均质材料中的含量均在GB/T 26572规定的限量要求以下。
×:表示该有害物质至少在该部件的某一均质材料中的含量超出GB/T 26572规定的限量要求。

