

说明书单页尺寸：190\*130mm

Portable Air Purifier

Breathe fresh air to your heart's content and enjoy a good life.

EPA EST. NO.101118-CHN-1

Portable  
Air Purifier  
User Manual

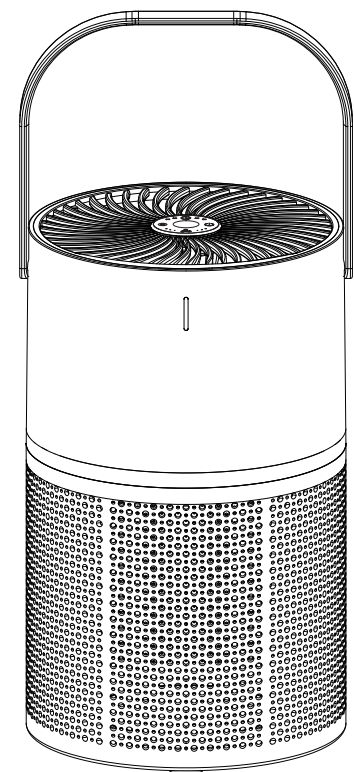

Model: GL-K802

# Contents

Product structure .....

1

Technical Specification.....

2

Operation Instruction .....

2

Notice Before Use.....

3

Product Performance .....

4

Usage Environment.....

5

Trouble Shooting.....

5

Cleaning & Filter Replacement.....

6

Easy to Install .....

6

Safety And Notification .....

7

Important .....

8

Maintenance Clause .....

9

Warranty Card .....

9

## Maintenance Clause

1.Maintenance objectives: the above products do not include consumable parts.Warranty service is free of charge within 1 year from the date you purchase the product, but proof of purchase must be provided.

2.Warranty scope: If the product failure or damage is caused by the following reasons, we will not provide free warranty service;

- Repair, maintenance, alteration of appearance or product parts or other improper use by a third party not authorized by the company.
- Use parts from other brands not approved by our company.
- Caused by failure to follow the instructions in the instruction manual of this product.
- Caused by natural disasters or other human factors that are not attributable to the company.

## Warranty Card

User name		VIP customer number		Contact number	
Address					
Invoice number			Purchase date		
Maintenance records					
Maintenance record delivery date	Fault description		Processing result		Clerk signature

- Welcome to choose this item of air purifier. In order to bring a better using experience and ensure safety, please read instruction manual carefully before using, and keep it well to check anytime.

## Technical Specification

Product name: portable air purifier	Model: GL-K802
Rated voltage: DC5V/1A	Power: 5W
Negative ion: $2 \times 10^7$ pcs/cm <sup>3</sup> (Optional)	Noise: 28-44dB
Product size: $\varnothing 158 \times 258$ mm	Net weight: 0.93Kg
Composite filter: $\varnothing 142 \times \varnothing 92 \times 142$ mm	USB: Type C
Mode: Sleep/Manual	Timer: 2/4/8h / Always
Wind: Sleep/Medium/High	

## Operating Instruction

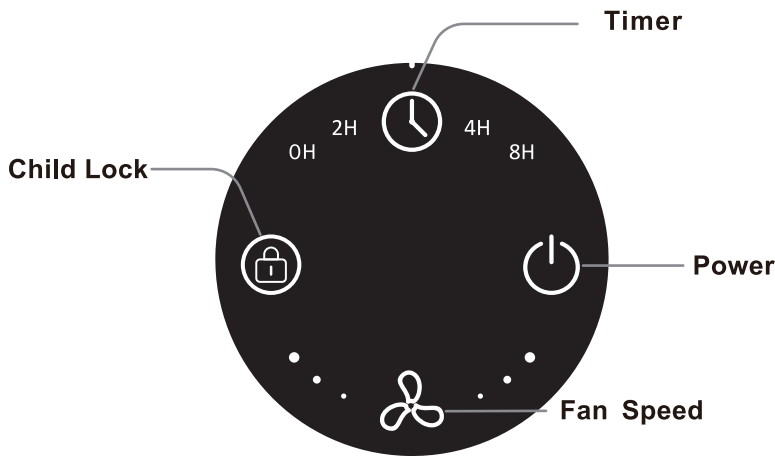

## Safety And Notification

Must read and follow the safety notice. To avoid causing injury to anyone, users must strictly follow the safety guide. Meaning of all warning symbols is specified below.

Neglect or misinterpret these warning symbols will cause the following situations:

	<b>Warning</b> The content of this symbol indicates "may cause bodily injury to people or death".
	<b>Attention</b> The content of this symbol indicates "may cause bodily injury to people and damage to properties".

Classified symbols to specify issues that must be strictly followed:

	Prohibited matters
	Compulsory matters
	Matters need to pay attention

**Warning**

**Do not contact the power cord with wet hands.**  
It may cause electric shock!

Do not contact with wet hands!

**Do not connect to power source, adaptor, socket power source or connection device exceed specified voltage limit. Use DC5V=1A only.**  
Using adaptor socket or power connection device exceed specific voltage limit will cause overheat to power cord and cause fire hazard.

Prohibited!

**Do not damage power cord or power socket.**  
Do not cut or scratch with sharp object; Do not alter, overfold, exceedingly stress, over-twist the power cord; do not sit heavy object(s) or squash the power cord. Using a damaged power cord may cause electric shock or fire hazard. Contact a qualified service center for power cord and plug repair and maintenance.

Prohibited!

**Do not move the unit by pulling its power cord.**  
Otherwise, it may cause short circuit or wire damage, result in fire hazard or electric shock.

Prohibited!

**Always unplug the unit before cleaning.**  
Otherwise, the unit may start functioning and cause electric shock.

Unplug!

**Make sure that you plug the appliance properly into a power socket. If the power cord plug is not completely plugged into a power outlet, this may cause overheat and result in electric shock and fire hazard.**  
Do not use a damaged plug or any power socket which cannot securely hold/does not fit the power cord plug.

Compulsory!

**Please clean the plug regularly. Dusts and moisture may damage the insulation area of the plug and causes fire hazard.**  
- pull out the plug and clean with dry cotton swab.  
- always unplug the unit if you do not intend to use for a long period of time.

Compulsory!

**Do not exceedingly stress the power cord while using the unit.**  
Otherwise, it may cause short circuit or wire damage, result in fire hazard or electric shock.





Prohibited!

## Important

Read below carefully and remember the important notice.









### Warning

 <p>Do not let water or any other liquid enter the unit.</p> <p>Do not spray liquid on the unit!</p> <p>To avoid electric shock!</p>	 <p>Do not attempt to disassemble or do alteration/modification to the unit.</p> <p>Prohibited!</p> <p>Unauthorized disassembling or alteration/modification may cause malfunction or fire hazard. ●Customer should contact authorized service provider to repair the unit.</p>	 <p>Do not block the air inlet and outlet, e.g. by placing bar shape or metal object.</p> <p>Prohibited!</p> <p>The foreign object may touch the inside parts causes electric shock or injury.</p>	 <p>Do not insert fingers or objects into the air outlet or the air inlet to prevent bodily injury.</p> <p>Be cautious of the product's orientation</p>
---	--	---	--



### Attention !

 <p>Do not use the unit in wet surroundings or in surroundings with high ambient temperatures, humidity or in an area where the unit will possibly be immersed by water, such as the bathroom, toilet, or kitchen.</p> <p>Do not let liquid get into the unit!</p> <p>To avoid electricity leakage, electric shock or fire hazard,</p>	 <p>Do not use alcoholic or dilute solvent, do not spray any flammable materials such as insecticides around the unit.</p> <p>Prohibited!</p> <p>These may damage the unit, causes injury, circuit short, electric shock or fire hazard,</p>	 <p>Do not use the unit in places of oily residues.</p> <p>Prohibited!</p> <p>Otherwise, this may damage the unit and cause injury. ●This air purifier is not a substitute of proper</p>
 <p>Do not let flammable materials, such as fragrance or burning incense enter the unit.</p> <p>Keep away from flame fire!</p> <p>Otherwise, it may cause fire hazard,</p>	 <p>Do not use this appliance when you have used indoor smoke-type insect repellents, burning incense, or chemical fumes.</p> <p>Prohibited!</p> <p>Otherwise, chemical substances may reside inside the unit and release through air outlet which will cause health hazard. ●Ensure thorough air ventilation is available in areas where pesticide is used previously indoor before using this unit.</p>	 <p>If both heater and air purifier operate within the same enclosed area, please ensure proper air ventilation is maintained in the area.</p> <p>Compulsory!</p> <p>Otherwise, it will cause carbon monoxide poisoning. This unit is unable to clear carbon monoxide.</p>

### Note

Please turn off the unit for the following occurrence(s):

- Function button(s) does(do) not respond.
- Power cord and plug become abnormally heated.
- Burnt smell or abnormal noise or vibration.

This appliance cannot be used by children, persons with reduced physical, sensory or mental capabilities.

Unless they are under proper guidance of qualified instructor.

## Product Structure

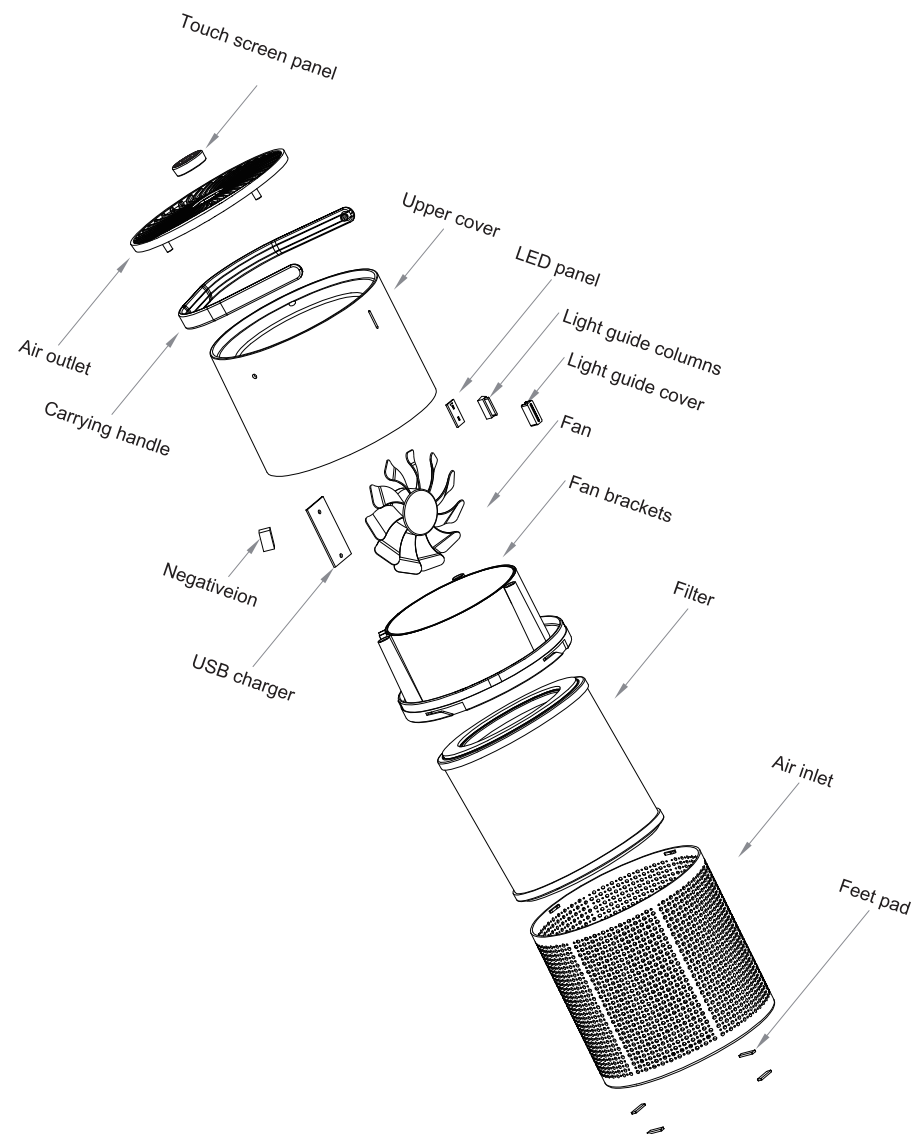



## Cleaning & Filter Replacement

Must be operated under power off status

### Clean:

Cleaning with wet wipers

### Replace filter:

Rotary the upper cover to "open" position, open air purifier, after changing new filter, aligning the upper cover line to "open" position, then rotary and aligning bottom "close" position, finished changing filter.

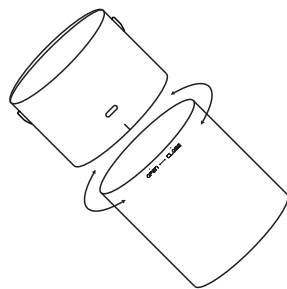

- Negative ions have a dust-settling effect, it's normal that there is much dust on air outlet, please clean on time.

## Easy To Install

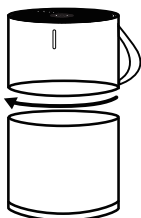

1. Unplug the air purifier, rotary the upper cover to "open" position open air purifier upper cover to "open" position open

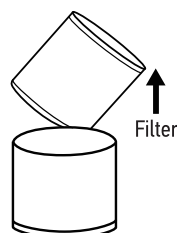

2. Remove the contaminated filter and install our new filter in position

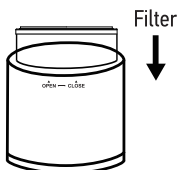

3. After changing new filter aligning the upper cover line to "open" position

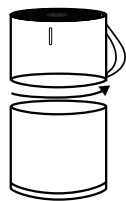

4. Rotary and aligning bottom "close" position, finished changing filter

### Power button:

Click Power Button to turn on unit, the timer, fan speed work at default mode, working indicator lights up. Press again to turn off, all function stop, and indicator shut off.

### Timer Button:

The default startup mode is continuous working. clicking the timer button, you can switch timer during 2H-4H-8H- continuous working-2H-....

Note: when the unit works for 1200 hours 0h, 2h, 4h, 8h light blinks remind you to check the status of filter if need replace or not, long press the timing button for 5 seconds, the buzzer rings, the filter is reset, and the machine remains in the current working state.

### Child Lock Button:

The default startup mode is child lock not work. the indicator is close, click the child lock button to lock all the operation panel, indicator lights up on white color, meanwhile can't operate the panel. Long press 3 seconds on the button to release, child lock unlocks, indicator shut off, and operation recover to work.

### Fan Speed Button:

The default startup is at mid speed. click fan speed button to switch the fan speed during High-Low- Mid-High..., if choose the sleep mode, the machine moves into sleep mode after 3 seconds, all press indicates on the panel shuts off, and the machine works at low fan speed. If you need to turn off the vertical bar light in front, long press the power button for 3S, the light turn off. Then press the power button again for 3S again, the light recover.

## Notice Before Use

1. To prevent electric shocks, please remove the power plug before maintaining or moving the appliance.
2. It is strictly prohibited to rinse the appliance with water. Do not use the appliance near water sources or volatile flammable items to prevent electric shocks.
3. Do not place any object into the power input port, otherwise unit cannot be operate.

4.Do not place any object into the air outlet area in order to prevent malfunction.

5.Suggested to place the unit in the area that children cannot be easily touch.

6.Do not use a wet hand to insert or remove the power plug to prevent electric shocks, and wipe the product with thinners such as gasoline, alcohol, etc.

7. Do not place the product in the bathroom or other places with high temperature.

8.It is forbidden to spray water, and the voltage should be consistent with the specified voltage.

### Product Performance

- 1) Purifying the air, absorbing dust, particle, hair and pollen, etc.
- 2) Removal of odor, smoke and TVOC, etc
- 3) Increasing the oxygen content in the air and produce health ions.

### Negative ions that is Air Vitamins

Ions with one or more negative charges are called "negative ions", also known as "anions".

On the one hand, air negative ions can adjust the concentration ratio of positive and negative ions, and on the other hand, they can purify the air. The negative ions can make the micron-level floating dust in the air invisible to the naked eye, attract and collide with the positive and negative ions to form molecular clusters and sink to the ground. , And negative ions can reverse the ambiguity of bacterial protein. And make the bacteria's viability decline or lethal. The characteristics of negative ion air purification are fast inactivation speed and high inactivation rate. It has an inactivation effect on microorganisms, bacteria and

viruses on the surface of the air and objects.

The negative ion technology we use can produce good biological activity and easily penetrate the human blood-brain barrier to enter the human body to exert its biological effects.

### Removable composite filter

The combination of polymer fiber and polymer activated carbon is adopted, and the triple filter screen fully filters and removes PM2.5 and degrades floats and sinks.

### Usage Environment

Suitable for indoor and dry environment. Do not spray with water. Do not place the product in the bathroom or other places where the temperature and friction are too high for use. The temperature is - 20°C~+60°C. Relative wet court ≤80%.

### Trouble Shooting

Malfunction	Checked Items	Solving Measures
The machine is not working	Is the power switched on?	Switch on the power, connect USB cable, check if it's connect with power.
No air Exhale	Filters carrying too many odors or dusts.	Check the filter,and replace it for necessary.
Machine have noise	Foreign items blocking the wind outlet our inlet.	Turning the unit upside down slitley, pouring out foreign objects. If still not workable, ask for help from professional repairer.
	The machine is placed in an unventilated place or is blocked by a barrier.	Put the machine on flat area.

- Other trouble shooting, please repair it on professional shop with your purchase vouchers and warranty card, or send back to factory for repair.